

ESPERANZA DRIVE

PASEO DE ROXAS

GREENBELT DRIVE

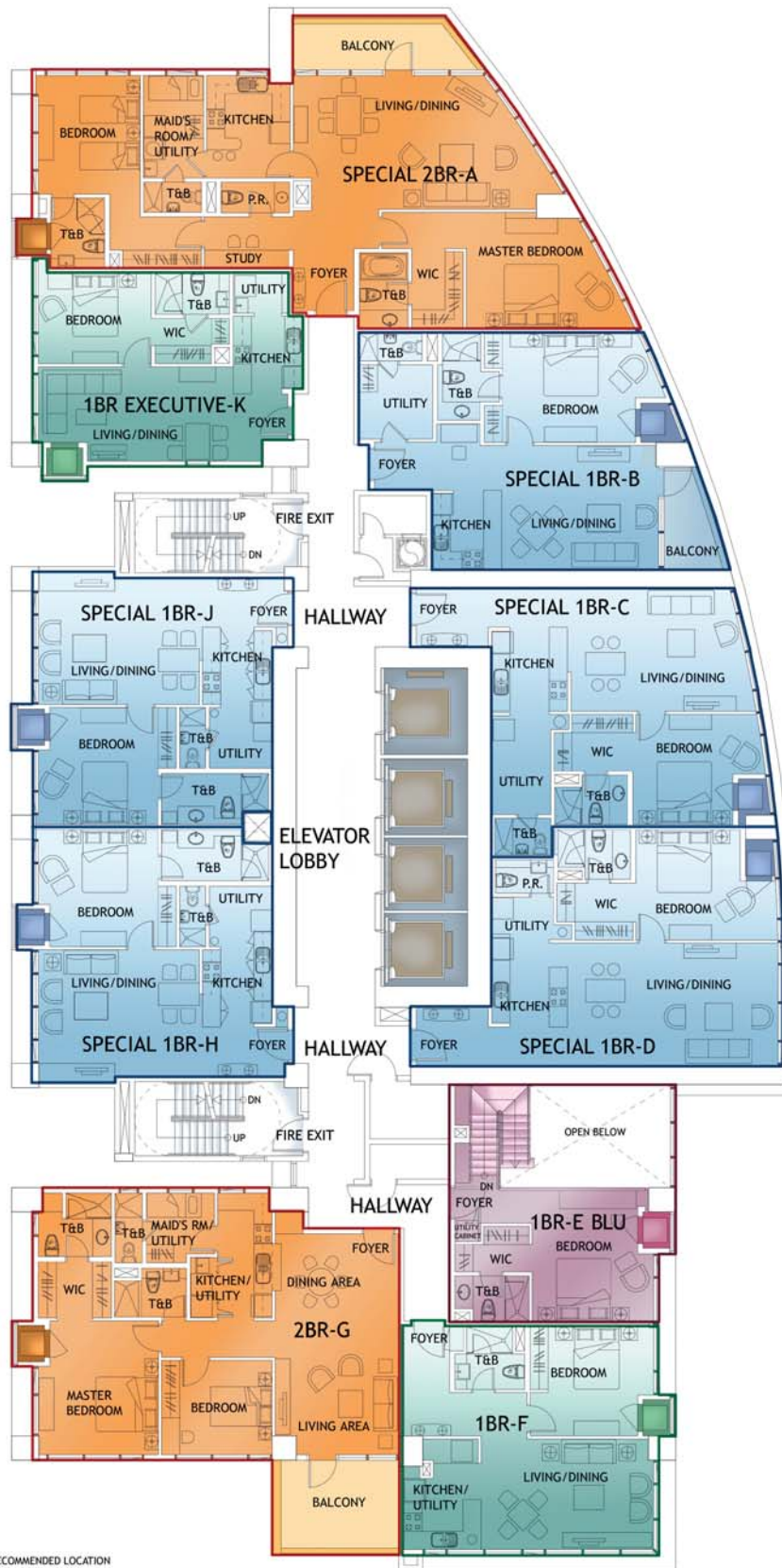

N

RECOMMENDED LOCATION FOR FLOOR-MOUNTED ACCU

ARNAIZ AVENUE

17TH, 19TH, 21ST, 23RD, 25TH, 27TH, 29TH, 31ST, 33RD & 35TH FLOORS UPPER LOFT

THE RESIDENCES

AT GREENBELT

MANILA TOWER

**17TH, 19TH, 21ST, 23RD, 25TH, 27TH,
29TH, 31ST, 33RD & 35TH FLOORS**
UPPER LOFT

GREENBELT DRIVE

UNIT	A	B	C****	D****	F	G	H****	J****	K
UNIT TYPE	SPECIAL 2-BR	SP 1-BR	SP 1-BR	SP 1-BR	1-BR	2-BR	SP 1-BR	SP 1BR	1-BR EXECUTIVE
FOYER	14	8	9	9	11	-	5	5	4
LIVING / DINING	38	23	25	30	23	38	26	26	23
KITCHEN / UTILITY	11	7	15	11	10	10	11	11	9
MASTER'S BEDROOM	23	20	17	18	18	21	19	19	13
MASTER'S T & B W/ W.I.C	10	6	9	9	4	12	7	7	8
BEDROOM - 1	22	-	-	-	-	13	-	-	-
T & B - 1	5	-	-	-	-	4	-	-	-
BEDROOM - 2	-	-	-	-	-	-	-	-	-
T & B - 2	-	-	-	-	-	-	-	-	-
POWDER ROOM	3	-	-	3	-	-	-	-	-
HALLWAY/ STORAGE	-	-	-	-	-	-	-	-	-
MAID'S ROOM/UTILITY	8	7	-	-	-	6	-	-	-
MAID'S T&B	3	3	3	-	-	2	2	2	-
TOTAL UNIT AREA (SQM)	137	74	78	80	66	106	70	70	57
BALCONY	10	5	-	-	-	13	-	-	-

* LINEN CABINETS AND STUDY NOT INCLUDED IN THE ACTUAL UNIT

** APPROXIMATE SIZES ONLY

*** WHILE DETAILS SHOWN HEREIN ARE BASED ON PRESENT PLANS, BUYERS ARE INVITED TO VERIFY FACTUAL CORRECTNESS AND SUBSEQUENT CHANGES LATER ON , IF ANY.

**** TOTAL UNIT AREA FOR SP 1-BR C AT THE 33RD & 35TH FLOORS IS APPROXIMATELY 79 SQM.

TOTAL UNIT AREA FOR SP 1-BR D AT THE 33RD & 35TH FLOORS IS APPROXIMATELY 81 SQM.

TOTAL UNIT AREA FOR SP 1-BR H & J AT THE 33RD & 35TH FLOORS IS APPROXIMATELY 71 SQM.

**** TO CONVERT TO SQUARE FEET, MULTIPLY AREAS BY 10.